

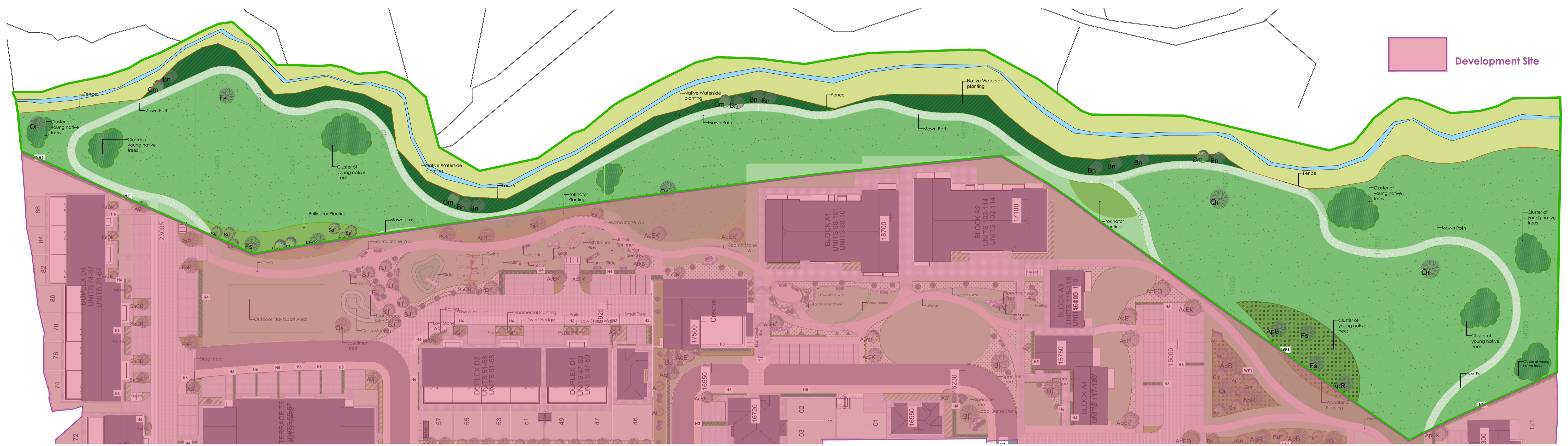

Native Trees - Crataegus monogyna (Hawthorn) Native trees - Quercus robur - (Oak) Native Trees - Sorbus aucuparia - (Mountain Ash) Pathway along playground with mown strip & native meadow grass open space



NH1 - Mixed Native & Naturalised Hedge (NH)

Species & variety	Common	Form	Spacing	400mm centres	%	Total 154/m
Fagus sylvatica	Beech	90-120cm	Bareroot whip	20%	77%	
Acer campestre	Field Maple	90-120cm	Bareroot whip	35%	135%	
Crataegus monogyna	Hawthorn	90-120cm	Bareroot whip	35%	135%	
Viburnum opulus	Guelder Rose	60-90cm	Bareroot whip	10%	39%	

Fence - 0.9m high, 3 strand wire, treated timber stakes at 2m centres, bracing at 10m centres

TREES LIST - Open Space - Carpark & Woodland (WP1) South of Apartments

Code	Species & variety	Size	Form	Securing	Quantity
ApB	Acer pseudo-buchemii	20-25cm girth	Rootball	Underground Guying system	3nr
ApA	Acer pseudo-buchemii	20-25cm girth	Rootball	Underground Guying system	3nr
Fs	Fagus sylvatica	20-25cm girth	Rootball	Underground Guying system	2nr
Qr	Quercus robur	20-25cm girth	Rootball	Underground Guying system	1nr
TCS	Tilia cordata 'Greenpire'	20-25cm girth	Rootball	Underground Guying system	2nr

MEADOW AREAS/WEST OF STREAM TREE LIST

Code	Species & variety	Size	Form	Securing	Quantity
Fs	Fagus sylvatica	18-20cm girth	Rootball	Double Stake & Crossbar	1nr
Qr	Quercus robur	18-20cm girth	Rootball	Double Stake & Crossbar	3nr
Bn	Betula nigra	12-14cm girth	Bareroot	Double Stake & Crossbar	10nr
Cm	Crataegus monogyna	12-14cm girth	Bareroot	Double Stake & Crossbar	4nr

OPEN SPACE PLAYGROUND & OUTDOOR PLAY AREA TREE LIST

Code	Species & variety	Size	Form	Securing	Quantity
AcEK	Acer campestre 'Ebirg'	18-20cm girth	Rootball	Double stake & crossbar	1nr
AcEK	Acer freemanii 'Autumn Blaze'	18-20cm girth	Rootball	Double stake & crossbar	1nr
Fs	Fagus sylvatica	18-20cm girth	Rootball	Double stake & crossbar	1nr
PaP	Prunus avium 'Plena'	18-20cm girth	Rootball	Double stake & crossbar	3nr
Qr	Quercus robur	25-30cm girth	Rootball	Underground Guying System	1nr

Mixed Shrub (Ornamental & Native) Planting with herbaceous perennials

Species & variety	Size/Form	Density
Cornus alba 'Spathe'	2 tr	1 per sqm
Eleagnus x ebbingei	2 tr	1 per sqm
Fuchsia 'Riccartonii'	2 tr	1 per sqm
Hydrangea in variety	2 tr	1 per sqm
Ilex 'Silver Queen'	2 tr	1 per sqm
Ilex 'Golden King'	2 tr	1 per sqm
Lonicera 'Maigraen'	2 tr	3 per sqm
Rosa rugosa*	2 tr	1 per sqm
Rosmarinus officinalis*	2 tr	1 per sqm
Rhododendron 'dwarf var'	2 tr	1 per sqm
Viburnum opulus*	2 tr	1 per sqm

Native & Naturalised Planting along Stream

Species & variety	Size/Form	Density
Achillea Summer Berries*	2 tr	5 per sqm
Crocus 'Lucifer'	2 tr	5 per sqm
Foeniculum vulgare*	2 tr	3 per sqm
Geranium 'Broadleaf'	2 tr	5 per sqm
Iris pseudoplatanus*	2 tr	5 per sqm
Ligularia przewalskii*	2 tr	3 per sqm
Rubus 'Goldstamm'	2 tr	5 per sqm



Native & Naturalised waterside planting along stream.



Mixed Shrub & Perennial planting to encourage biodiversity, colour & seasonal interest.

Woodland Groundcover Planting list to South Open Space

Species & variety	Size	%	Density
Colonywaxer Coral Beauty*	2 tr	10%	3 per sqm
Erica in variety*	2 tr	10%	5 per sqm
Geranium 'Bevon's Variety'	2 tr	10%	3 per sqm
Geranium 'Blackout'	2 tr	10%	3 per sqm
Hedera helix*	2 tr	15%	3 per sqm
Polychitum setiferum	2 tr	15%	3 per sqm
Vinca minor 'Rough Stager'	2 tr	15%	3 per sqm
Rubus 'Ticouca'	2 tr	15%	3 per sqm

Soil Depths Required on site:

Mown Grass - Public Open Space with development
Substrate: Armenty Grass mix

Mown Grass - Private Space
Substrate: Armenty Grass mix

Meadowgrass - Open Space
Meadowgrass seed (ref Wildflowers.ie Design By Nature)
Seed Mix MMS - Moist Acid Soils
Seed Mix EC05 - Wetlands
Seed Mix MM11 - Free Draining acid soils in high rainfall areas.



Native Wildflower meadow grass with mown pathways

PLEASE NOTE:

THIS DRAWING, THE DESIGN AND ITS CONTENTS ARE COPYRIGHT, ALL RIGHTS RESERVED.

NO PART OF THIS DRAWING CAN BE COPIED OR REPRODUCED IN ANY FORM WHATSOEVER, PARTLY OR COMPLETELY WITHOUT PRIOR WRITTEN CONSENT OF THE COPYRIGHT OWNERS RADHARC LANDSCAPING LTD.

THIS DRAWING HAS BEEN PREPARED SOLELY FOR THE PURPOSE OF PLANNING PERMISSION.

THIS DRAWING IS NOT TO BE RELIED UPON FOR CONSTRUCTION AND NO GUARANTEE IS GIVEN AS TO ITS SUITABILITY FOR CONSTRUCTION.

ALL CONTRACTORS, WHETHER MAIN OR SUBCONTRACTORS MUST VISIT THE SITE AND ARE RESPONSIBLE FOR TAKING AND CHECKING ANY AND ALL DIMENSIONS AND LEVELS THAT RELATE TO THE WORKS. ALL DIMENSIONS TO BE CHECKED ON SITE BY CONTRACTOR.

GENERAL NOTES:

- All soil movement should take place during dry weather (when topsoil is not wet);
- Topsoil should be stripped first & stored separately from subsoil. All topsoil to be good quality medium loam and free from deleterious material;
- Organic matter to be added when necessary to create a good friable structure;
- Soil depth: for trees 100mm (40% free draining subsoil, 60% topsoil); for general planting 700mm;
- All grass levels to be raised 100mm above kerb level;
- All landscape treatment subject to engineers' approval for structural, moisture and drainage considerations;
- Gravel or hard surface line between all planting and buildings, approx width 300mm;
- 1m high black shelter fencing should be erected for the first two seasons in wind vulnerable areas;
- Bark mulch dress to 50mm depth should be added to all ornamental planting and replenished annually to maintain depth.

HATCH NOTE:

The drawing hatch is graphic indication & not intended as an accurate representation of finished work. Paving and other hard/soft finishes will vary on completion. Please discuss further with Radharc regarding material finishes.

TREES & SHRUBS (PLANTING, CARE & MAINTENANCE):

- Trees to be supported by staking depending on size: 1.4-1.8m trees planted in prepared tree pits, 900 x 900 x 1000mm. Secured with double stake and cross bar; 16-18 cm girth - Secured with double stake and cross bar;
- Containerised shrubs to be planted at any time of the year but avoiding periods of frost, water logging or drought;
- Bareroot trees to be planted in the period of Nov-March;
- Shelter Fencing to be erected during establishment phase.

MAINTENANCE:

- Weed control by residual chemical and by regular spot treatment with translocated herbicide (e.g. Glyphosate) during the growing season. Weeds among plants to be hand weeded where necessary;
- Pruning of all plants to be carried out by a competent horticulturist in accordance with good practice;
- Watering: all planting to be kept well watered during dry weather, especially during establishment phase.

Radharc

landscape design

Private Commercial Residential

Ballinahalla, Moycullen, Co. Galway, H91 KAK3
Tel: (091) 555078 Fax: (091) 555956
e-mail: info@radharclandscaping.com
www.radharclandscaping.com

Stage 3 - SHD

Drawing Purpose: FOR PLANNING

Project: Beama SHD, Beama, Co Galway

Client: Burkeway Homes

Drawing title: Biodiversity/Ecological Mitigation_Zoned Open Space

Drawing No.: 924_Rad_1973_07_Biodiversity/Ecological Mitigation_Zoned Open Space

Scale: 1:500@A1 **Drawn by:** SG

Date: 30/09/2020 **Checked by:** BW

Do not scale from this drawing. All dimensions to be checked on site. Discrepancies between this drawing and information given elsewhere must be reported to this office for clarification before proceeding